

tGEAR High-Speed Gearbox - Factsheet

WLTC_testcycles and efficiency mapping for e-motors on conventional test beds.

WLTP testcycles

WLTC Class 3

Time [s]

Modular system

Efficiency mapping

Vibration optimized

tGear Overview		
Transmission ratio	3.125*	
Maximum power	600	kW
Maximum input speed	8000	rpm
Maximum output speed	25000	rpm
Maximum input torque	1800	Nm
Maximum output torque	600	Nm

* Customizable between 2-7

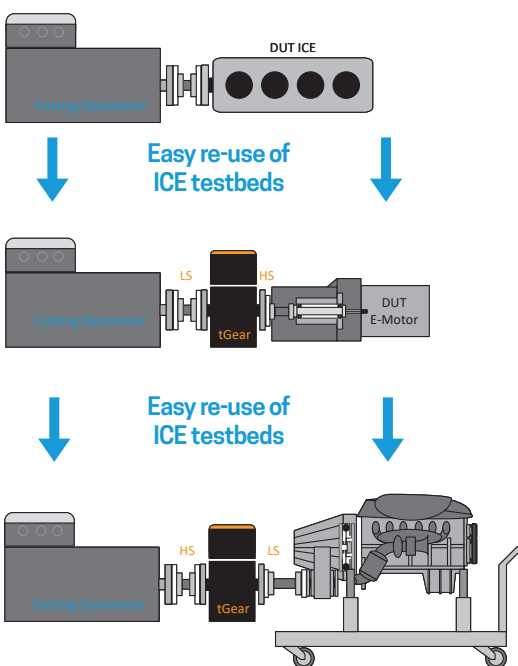

Electrical connection & sensors

400V 3/N/PE 50Hz
Power: max. 1 kW
5x PT100
1x oil pressure switch

Cooling water

Supply: quick coupling HNV34GASM5 male
Return: quick coupling HNV34GASM5 sleeve
Pressure: max. 2 bar
Cooling capacity: max. 4 kW
Supply temperature: 15-30°C
Consumption: 0.6 - 1.8 m³/h
Permitted fluids :
- Pure water
- Glycol/water mixture (35 - 50% glycol)

Dimensions

Length: 473.5 mm
Width: 590 mm
Height: 1105 mm
Weight: 450 kg

If you have any questions or would like to know more about tGear, please contact:

tectos GmbH

Tel.: +43 316 22 86 17

E-Mail: sales@tectos.at